

Toilet Tissue Holder (Double) – Chrome Plated – Surface Mounted

Toilet Tissue Dispensers

MasterFormat Section 10 28 13

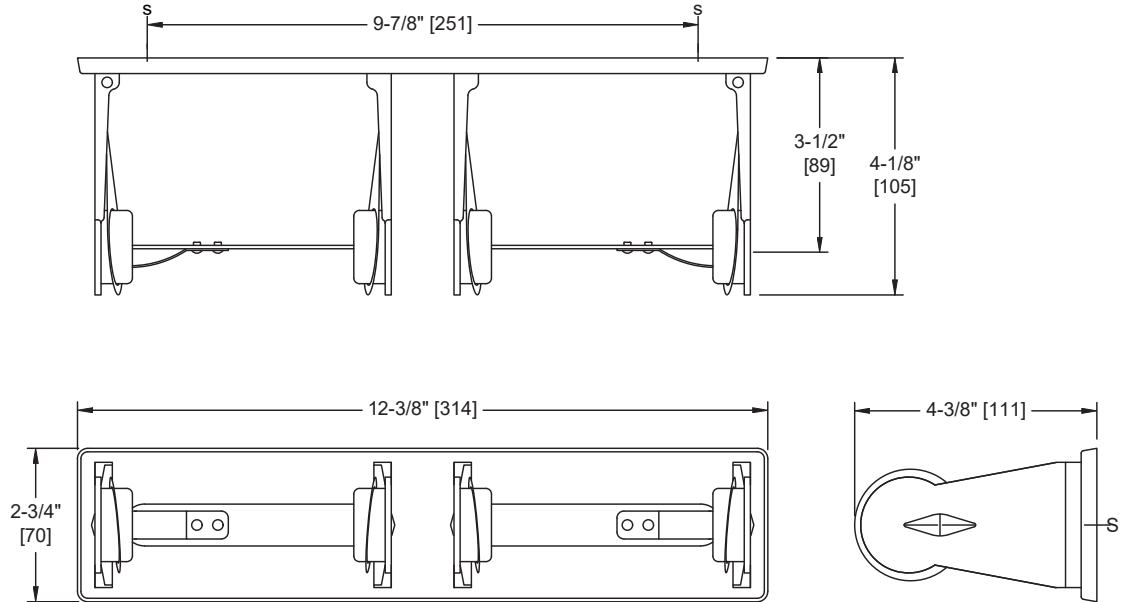
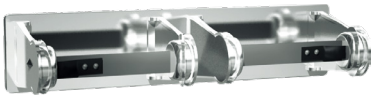

Scan for
Information



SUSTAINABILITY/LEED

MR 4.1 (1) MR 6 (1) EQ 4.2 (1)
MR 4.2 (1) EQ 4.1 (1) EQ 4.4 (1)

NOTE:
ALL DIM'S INCH [MM]
ILLUSTRATION FOR REF ONLY AND NTS

PRODUCT OVERVIEW

Holds two (2) rolls of standard core size toilet tissue up to 6" diameter [Ø152] and 4-1/8" [105] to 4-3/4" [121] wide. Unit fabricated of polished chrome-plated steel. Roll shall be non-removable until roll is depleted. Brake springs shall allow free delivery for each roll of toilet paper while preventing over-spin paper roll-off due to fast-pull. Roll is replaced on a cycle determined by maintenance needs. Roll cores prevent access to release catches and must be removed to allow end support arms to swing away for service roll replacements.

KEY FEATURES & SPECIFICATIONS

- Double Roll Dispenser
- 18 Gauge Chrome Plated Steel with High Polish
- Surface Mounted

OPERATION & MAINTENANCE

Toilet paper is dispensed with free delivery from each roll while preventing over-spin from fast-pull. Roll is replaced on a cycle determined by maintenance needs. Roll cores prevent access to release catches and must be removed to allow end support arms to swing away for service roll replacements.

TECHNICAL INFORMATION / PRODUCT PROPERTIES

Property	Value
Dimensions	12-3/8" [314] W x 2-3/4" [70] H x 4-1/4" [108] D
Construction	18 Gauge Chrome Plated Steel with High Polish
Mounting	Surface Mounted
Capacity	Holds two (2) rolls of standard core roll toilet paper up to 6" Dia. [Ø152]

INSTALLATION

For general utility, mount unit 32" [813] AFF (Above Finished Floor) from center line of holder. Surface mount and secure holder to wall with two (2) #10 self threading screws (supplied by others) through mounting slots in back plate. For compliance with 2010 ADA Accessibility Standards and 2015 ABA Standards install unit so that center line of roll is 7" [178] min front of the water closet to 9" [229] max and outlet of roll is 15" [381] min AFF to 48" [1219] max AFF.

OPTIONS

WARRANTY

One (1) Year from date of Invoice