

Vanity Mounted Automatic Soap Dispensing System Foam Soap Dispenser

Soap Dispensers

MasterFormat Section 10 28 13

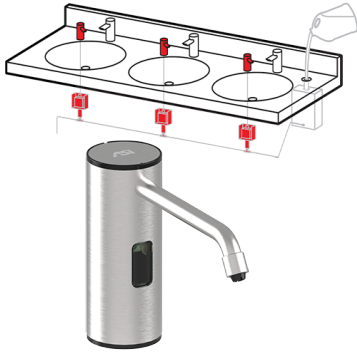

Scan for Information



SUSTAINABILITY/LEED

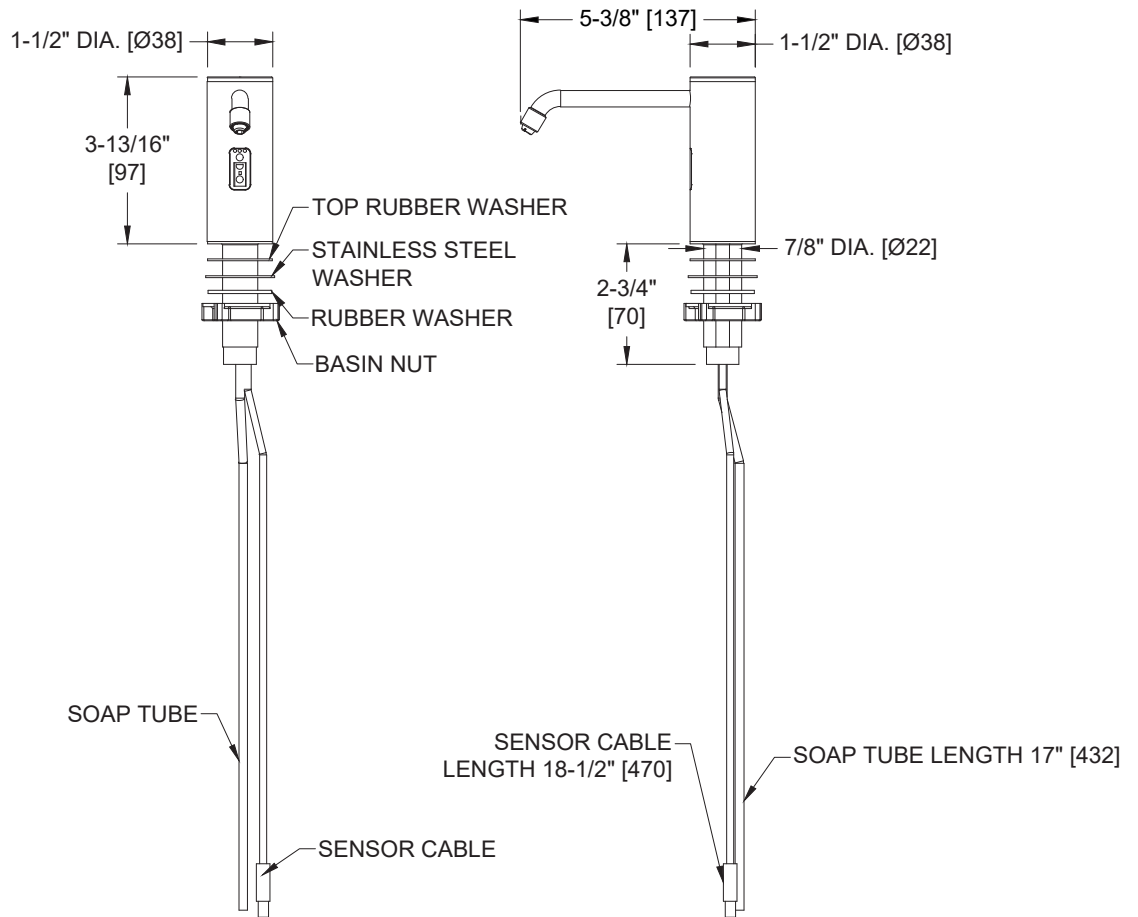

NOTE:
ALL DIM'S INCH [MM]
ILLUSTRATION FOR REF ONLY AND NTS
SEE SOAP DISPENSER CARE & MAINTENANCE
DOCUMENT ONLINE FOR CLEANING

PRODUCT OVERVIEW

Vanity Mounted Automatic Soap Dispensing System Foam Soap Dispenser shall dispense foam soap in stream cycles with foam volume ranging approximately 0.24 ~ 0.3 oz [7 ~ 9 ml] using 0.02 ~ 0.03 oz [0.7 ~ 0.9 ml] liquid for each activation when connected properly to control-pump module Model 0385 in appropriately configured system. Viscosity Range (mPa*s or cP): 1 - 100. pH Range: 5.5 ~ 8.5. Soaps containing reportable salts, chlorides and alcohols should be avoided.

KEY FEATURES & SPECIFICATIONS

- Type 304 Stainless Steel - Satin Finish
- Vanity Mounted
- Automatic - AC - "No Touch"
- Battery Option with Model 0385-BP separately
- Foam Soap

OPERATION & MAINTENANCE

Sensor detection range shall be preset at 4-3/4" ± 1-1/2" [121 ± 38] and shall self-compensate for lighting conditions. An indicator LED shall provide status notification of user sensor detection. Unit shall mount on vanity deck up to 2" [51] thick through 1" Dia. [Ø25] hole minimum to 1-1/4" Dia. [Ø32] max. Soap supply shall be from Control Module (Model 0385, provided with system) connected to Vanity Mounted Top-Fill Tank (Model 0387, provided when ordered with system) with capacity of 1.6 gal (6 L) of foam soap containing no abrasives or particulates.

TECHNICAL INFORMATION / PRODUCT PROPERTIES

Property	Value
Dimensions	1-1/2" DIA. [Ø38] x 3-13/16" [97] high
Construction	Type 304 Stainless Steel - Satin Finish
Mounting	Vanity/Counter Mount - Attaches to a 1.6 gal (6 L) tank bought separately
Options	N/A

INSTALLATION

Install unit to counter top with washers and basin nut (supplied) into 1" Dia. [Ø25] hole located in counter top per template or to suit site conditions. Connect soap supply tube from dispenser shank to fitting on top of control module (Model 0385, provided with system). Connect COM cable with multi-pin socket into control unit inline cable connector

WARRANTY

One (1) Year from date of Invoice